

*Numbers based on 10-Year CIP Draft
 **Number based on 2020 Water Supply Report

SFEs are Approximate and Based on Best Practices and Best Available Data

North System SFE Capacity by Appurtenance

Official SFE = 948
 SFE By Address = 1231
 North System Maryvale SFE = 200

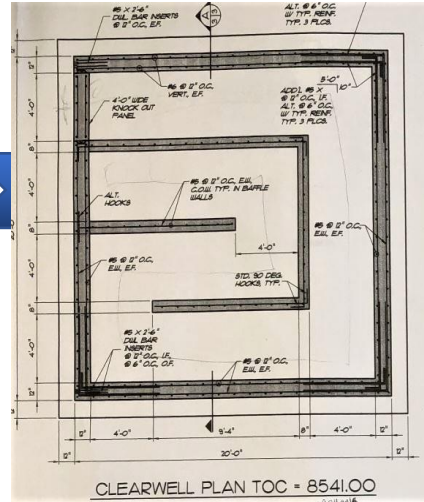
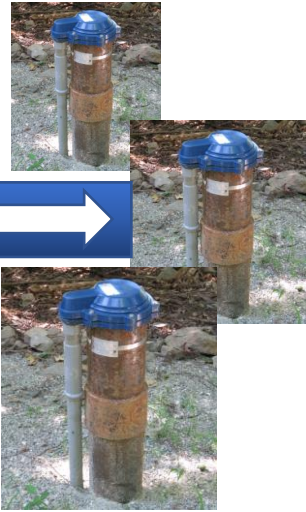
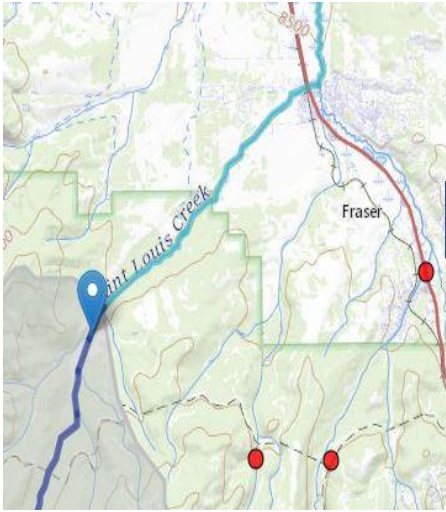

Fraser Water Right

2.28 cfs.**

Legal Supply Limit
1023 gpm**

1300 to 2800 SFE**

Limit set by Max Day Demand

Wellfield

Safe Yield
399 GPM**

2022
Max Day Demand
304 gpm*

820 SFE**

Limit set by Winter Production

Water Treatment

At 0.5 ppm Cl2
600 GPM
(per CDPHE Filing)

1000 SFE

May be adjusted by increasing
Cl2 Residual

Booster Pumps

Safe Yield
275 GPM

2022
Max Day Demand
304 gpm*

600 SFE**

Limit set by Single Pump Offline

Storage Tank 1 Million Gallons

4 Days Supply
Mid Summer
or
1 Fire Engine for
10 hours

(3000 gpm for 3 hours and 130% Max Day Demand*)

900 EQR*

Limit Fire Flow Requirements

*Numbers based on 10-Year CIP Draft
 **Number based on 2020 Water Supply Report

EQRs are Approximate and Based on Best Practices and Best Available Data

South System EQR Capacity by Appurtenance

Official EQR = 571
 EQR By Address = 694
 North System Grand Park EQR = 200

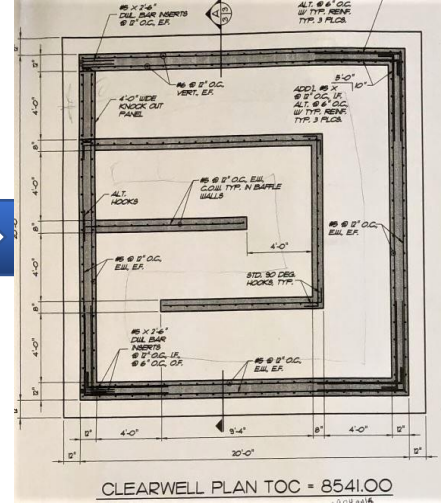
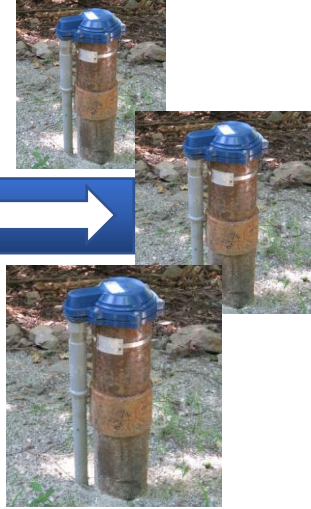
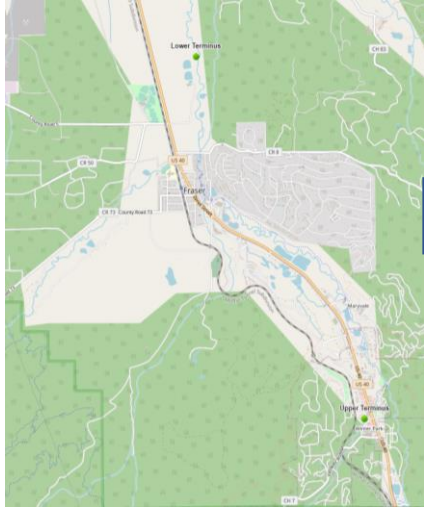

Maryvale Augmentation Plan

Additional Augmentation Needed
 For Full Buildout

Legal Supply Limit
1597 gpm**

2822 EQR**

Limit set by Decree

Wellfield

Safe Yield
 241 GPM**

2022
 Max Day Demand
235 gpm*

840 EQR**

Water Treatment

Max CT
 @
 0.5 ppm Cl₂
700 gpm

1220 EQR

May be adjusted by increasing
 Cl₂ Residual

Booster Pumps

Safe Yield
 302 GPM

2022
 Max Day Demand
242 gpm*

670 EQR**

Limit set by Single Pump Offline

Storage Tanks 0.8 Million Gallons

10 Days Supply
 Mid Summer
 or
 1 Fire Engine for
8 hours

(3000 gpm for 3 hours and 130%
 Max Day Demand*)

484 EQR*

Limit set by Demand and Fire
 Flow Requirements

The Take Away



- North Treatment Plant, Additional Booster Pump
- North System, 1-2 Additional Wells within 5 Years
- Additional Storage Tanks in Both Systems
- OoTSA Buildout, Additional Water Supply and Treatment (Gaskill Ditch?)
- South System, Additional Booster Pump in 5 Years
- South System, 1-2 Additional Wells in 10-Years
- Augmentation Reservoir, Prior to Buildout (Elk Creek Water Right)